

Lifting Eye FP

Product information



The Flat Point is a rotatable attachment point with screw for lifting and load attachment applications. It is used where a low-profile lifting point is needed with defined WLL values and controlled load orientation.

Best used for:

- Machinery, tooling, and components requiring flat lifting points.
- Applications needing 360° rotation and 110° working range.

Product benefits:

- Flat design supports use where installation height is limited.
- Rotates 360° for easier alignment during lifting.
- Automatically locking link helps maintain controlled positioning.
- Crack-tested 10.9 screw supports documented lifting reliability.
- WLL range from 0.5 to 15 t supports load planning.

... [Read more](#)

Material: Eye and swivel of alloy steel.

Marking: CE-marked, UKCA-marked, WLL.

Finish: Painted.

Note: The surface that the lifting eyes shall be attached to shall be flat and tolerate the load it is going to be exposed to.

Safety factor: 4:1

Lifting Eye FP

Blueprint

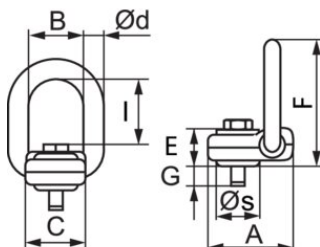

Technical data

Part code	Code	WLL ton	Thread	Torque Nm	A mm	B mm	C mm	Ø d mm mm	E mm	F mm	G mm	I mm	Øs mm mm	Weight kg
42150381100000	FP 0.5	0.5	M10	40	69	50	48	13	28	100	12	52	34	0.71
42150381101000	FP 0.8	0.8	M12	65	69	50	48	13	28	100	17	51	34	0.73
42150381101500	FP 1.5	1.5	M16	160	69	50	48	13	28	100	27	49	34	0.77
42150381102100	FP 2.5	2.5	M20	420	69	50	48	13	33	103	37	44	41	0.92
42150381104200	FP 4-S	4	M24	750	69	50	48	13	34	103	46	40	41	1.05
42150381104000	FP 4	4	M24	750	104	76	78	18	39	147	41	74	58	2.5
42150381105000	FP 5	5	M27	1,000	104	76	72	18	39	147	51	72	58	2.63
42150381106000	FP 6	6	M30	1,400	104	76	72	18	39	147	51	70	58	2.74
42150381108000	FP 8	8	M36	1,800	104	76	72	18	43	147	57	62	58	3.15
42150381110000	FP 10	10	M42	2,000	160	107	99	34.5	65.5	236	44.5	110	90	10.4
42150381115000	FP 15	15	M48	2,000	160	107	99	34.5	65.5	236	54.4	106	90	11