

## Pulley Block Svero Ball-bearing

---

### Product information



Sheave bracket with ball bearings.

- electro-galvanized holder and powder-coated sheave
- turned sheave with ball bearing
- own production numbers as well as test loaded ones
- test and CE certificates and manual included
- traceable with unique SVERO serial number

... [Read more](#)

---

**Marking:** According to standard, CE-marked, WLL

**Temperature range:** -10° C up to +50° C

**Standard:** EN 13157

**Safety factor:** 4:1

## Pulley Block Svero Ball-bearing

### Blueprint

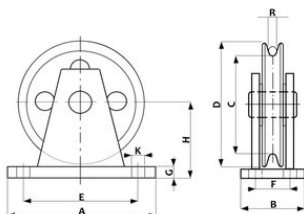

### Technical data

Part code	Rope Ø range mm	WLL ton	A mm	B mm	C mm	D mm	E mm	F mm	G, mm	H, mm	K mm	Rmm mm	Weight kg
140100500460	5	0.125	-	-	-	60	-	-	-	-	-	-	0.6
140100600460	6	0.25	-	-	-	70	-	-	-	-	-	-	0.8
140100700460	7	0.5	120	60	78	100	90	30	8	60	10	7	1.53
140100800460	8	1	140	60	98	125	110	35	10	77	12	8	2.3
140101000460	10	2	180	80	8	150	140	40	12	92	14	10	5.7
140101200460	12	3	230	100	160	200	180	50	15	120	18	12	8.2
140101500460	15	5	320	120	225	275	260	60	20	165	23	15	21