

Snatch Block with Hook POWERTEX PSBH-S2

Product information



The POWERTEX PSBH-S2 snatch block with hook is a heavy-duty snatch block that can be used for temporary or permanent lifting and pulling installations. The block can be used to redirect a wire rope or increase the load that a wire rope winch arrangement could handle in a straight loading without a block.

The wire rope is easily inserted by removing the hair needle pin, unwinding the quick bolt and turning the side plate.

Features:

- Safe - each snatch block is proof load tested 2 x WLL and examined in the factory prior delivery
- Safe - the quick bolt is designed to be positively held in place also when the block is open
- Safe - the swivel assembly is designed to be securely locked also when the block is open
- Durable - forged/machined precision sheaves
- Conical roller bearings (8t and up) or bronze bearings (2t and 4t)
- 2 grease nipples for quick maintenance of moveable parts
- Forged swivel hook with safety latch
- Sturdy side plates that protect the moveable parts
- Identification plate made of metal instead of sticker
- RFID equipped (chip) for easy service, inspection and asset control
- Marked with QR code to allow access to user manuals at any time
- 2.2 Test certificate and Declaration of conformity delivered with each block
- 14 language user manuals delivered with each block
- QR code for on-site access to multilanguage user manuals
- Fulfills Machinery Directive 2006/42/EC

... [Read more](#)

Material: Robust steel construction

Marking: CE-marked, POWERTEX, Model, WLL, Manufacturing date and Serial number, UKCA

Temperature range: -20°C up to +50°C

Finish: Red painted

Safety factor: 5:1

Snatch Block with Hook POWERTEX PSBH-S2

Blueprint

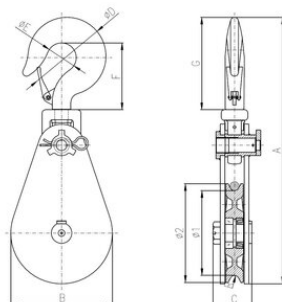

Technical data

Part code	Code	Rope Ø range mm	WLL ton	Sheave dia mm	Sheave dia. inch	A mm	B mm	C mm	D mm	E mm	F mm	G, mm	Rmm mm	ø1 mm	ø2 mm	Weight kg
424100200600	PSBH-S2/2T-75-10	7-10	2	75	3	305	82	70	98	38	83	113	5.3-5.5	58	75	3.9
424100400600	PSBH-S2/4T-115-13	10-13	4	115	4.5	353	120	70.5	122	50	103	140	6.8-7.15	90	115	6.3
424100400605	PSBH-S2/4T-150-19	16-19	4	150	6	432	160	70.5	122	50	108	145	9.98-10.45	120	150	9.8
424100800600	PSBH-S2/8T-200-22	19-22	8	200	8	550	210	94	162	60	141	198	11.55-12.1	165	200	19
424101200600	PSBH-S2/12T-250-26	23-26	12	250	10	750	260	115	228	85	216	294	13.65-14.3	205	250	43.8
424101500600	PSBH-S2/15T-200-24	22-24	15	200	8	673	210	102	228	85	203	274	12.60-13.2	160	200	33
424101500605	PSBH-S2/15T-300-26	23-26	15	300	12	813	310	133	228	85	215	290	13.65-14.3	250	300	59
424102200600	PSBH-S2/22T-350-32	28-32	22	350	14	960	365	140	280	106	240	333	16.8-17.6	295	350	99