

Swageless Terminal with Eye

Product information

Swageless stainless eye terminal for safe, reliable and machine free self assembly
... [Read more](#)

Material: Stainless steel AISI 316.

Temperature range: -50°C to +100°C and briefly up to +200°C

Finish: High polished.

Warning: Read assembly instructions before use!



Swageless Terminal with Eye

Blueprint

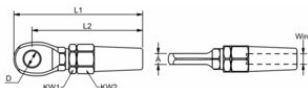

Technical data

Part code	Rope Ø range mm	MBL ton	Rope Ø inch	A mm	D, mm	L1mm mm	L2mm mm	KW1 mm	KW2 mm	Weight kg/100pc
1207821903	3	0.75	1/18"	5,5	6.5	58.6	50.1	13	12	4
1207821904	4	1.5	5/32"	7	8.5	71.4	60.4	13	14	7.3
1207821905	5	2.18	-	8	10.5	81.5	69.5	17	16	9.8
1207821906	6	3.7	1/4"	9	13	96	82	19	19	15
1207821907	7	4.7	9/32"	9	13.2	105	89.5	22	22	21.2
1207821908	8	5.6	5/16"	10	14.5	117	100.5	24	24	28.1
1207821910	10	8.3	-	13	16.2	137	117	27	27	46
1207821912	12	12	-	15	19.5	161	139.5	32	32	72
1207821914	14	14	-	18	23	187.6	161.6	36	36	110
1207	16	23	5/8"	20	26	214	185	41	41	160