

Thread Terminals Metric - TTM

Product information

TTM (Thread Terminals Metric) are stainless steel threaded terminals for pressing or swaging onto stainless steel wire rope. They are used to put tension on a wire, either with the help of nuts and washers or as part of a rigging screw.

Features:

- Wide range of sizes
- Available in right hand and left hand threads.
- Other sizes or UNF thread available on request
- Available with or without a nut.

[... Read more](#)



Material: Stainless steel AISI 316

Temperature range: -50°C to +100°C and briefly up to +200°C

Finish: High polished.

Note: Part codes ending in an "N" include a nut.

Warning: It is strongly recommended to lubricate threads first, before tensioning.

Thread Terminals Metric - TTM

Blueprint

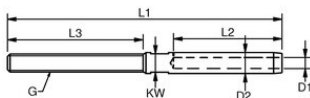

Technical data

| Part code | Rope Ø range mm | MBL ton | Thread | G thread mm | D1mm mm | D2mm mm | L1mm mm | L2mm mm | L3 mm mm | KWmm mm | Weight kg/100pc |
|-------------|-----------------|---------|-----------|-------------|---------|---------|---------|---------|----------|---------|-----------------|
| 1207900205N | 2 | 0.8 | R* | M5 | 2.2 | 5.5 | 80 | 24 | 42 | 4.5 | 1.4 |
| 1207910205N | 2 | 0.8 | M5 - Left | M5 | 2,2 | 5,5 | 80 | 24 | 42 | 4,5 | 1.4 |
| 1207900205 | 2 | 0.8 | R* | M5 | 2.2 | 5.5 | 80 | 24 | 42 | 4.5 | 1.4 |
| 1207910205 | 2 | 0.8 | L* | M5 | 2,2 | 5,5 | 80 | 24 | 42 | 4,5 | 1.4 |
| 1207902505N | 2.5 | 0.8 | R* | M5 | 2,8 | 5,5 | 82 | 27 | 42 | 4,5 | 1.5 |
| 1207912505N | 2.5 | 0.8 | M5 - left | M5 | 2,8 | 5,5 | 82 | 27 | 42 | 4,5 | 1.5 |
| 1207902505 | 2.5 | 0.8 | R* | M5 | 2,8 | 5,5 | 82 | 27 | 42 | 4,5 | 1.5 |
| 1207912505 | 2.5 | 0.8 | L* | M5 | 2,8 | 5,5 | 82 | 27 | 42 | 4,5 | 1.5 |
| 1207900306N | 3 | 1.2 | R* | M6 | 3,3 | 6,35 | 100 | 38 | 48 | 5,0 | 2 |
| 1207910306N | 3 | 1.2 | L* | M6 | 3,3 | 6,35 | 100 | 38 | 48 | 5,0 | 2 |
| 1207900306 | 3 | 1.2 | R* | M6 | 3,3 | 6,35 | 100 | 38 | 48 | 5,0 | 2 |
| 1207910306 | 3 | 1.2 | L* | M6 | 3,3 | 6,35 | 100 | 38 | 48 | 5,0 | 2 |
| 1207900406N | 4 | 1.2 | R* | M6 | 4,4 | 7,50 | 110 | 45 | 48 | 6,0 | 2.4 |
| 1207910406N | 4 | 1.2 | L* | M6 | 4,4 | 7,50 | 110 | 45 | 48 | 6,0 | 2.4 |
| 1207900406 | 4 | 1.2 | R* | M6 | 4,4 | 7,50 | 110 | 45 | 48 | 6,0 | 2.4 |
| 1207910406 | 4 | 1.2 | L* | M6 | 4,4 | 7,50 | 110 | 45 | 48 | 6,0 | 2.4 |
| 1207900408N | 4 | 1.7 | R* | M8 | 4,4 | 7,50 | 117 | 45 | 57 | 6,0 | 3 |
| 1207910408N | 4 | 1.7 | L* | M8 | 4,4 | 7,50 | 117 | 45 | 57 | 6,0 | 3 |
| 1207900406 | 4 | 1.7 | R* | M8 | 4,4 | 7,50 | 117 | 45 | 57 | 6,0 | 3 |
| 1207910408 | 4 | 1.7 | L* | M8 | 4,4 | 7,50 | 117 | 45 | 57 | 6,0 | 3 |
| 1207900508N | 5 | 2.2 | R* | M8 | 5,3 | 9,00 | 123 | 51 | 57 | 7,0 | 4 |
| 1207910508N | 5 | 2.2 | L* | M8 | 5,3 | 9,0 | 123 | 51 | 57 | 7,0 | 4 |

Thread Terminals Metric - TTM

Technical data

| Part code | Rope Ø range mm | MBL ton | Thread | G thread mm | D1mm mm | D2mm mm | L1mm mm | L2mm mm | L3 mm mm | KWmm mm | Weight kg/100pc |
|-------------|-----------------|---------|--------|-------------|---------|---------|---------|---------|----------|---------|-----------------|
| 1207900508 | 5 | 2.2 | R* | M8 | 5,3 | 9,00 | 123 | 51 | 57 | 7,0 | 4 |
| 1207910508 | 5 | 2.2 | L* | M8 | 5,3 | 9,0 | 123 | 51 | 57 | 7,0 | 4 |
| 1207900510N | 5 | 2.5 | R* | M10 | 5,3 | 9,00 | 130 | 51 | 63 | 7,0 | 4.5 |
| 1207910510N | 5 | 2.5 | L* | M10 | 5,3 | 9,00 | 130 | 51 | 63 | 7,0 | 4.5 |
| 1207900510 | 5 | 2.5 | R* | M10 | 5,3 | 9,00 | 130 | 51 | 63 | 7,0 | 4.5 |
| 1207910510 | 5 | 2.5 | L* | M10 | 5,3 | 9,00 | 130 | 51 | 63 | 7,0 | 4.5 |
| 1207900610N | 6 | 3.5 | R* | M10 | 6,5 | 12,58 | 145 | 64 | 63 | 11 | 8.4 |
| 1207910610N | 6 | 3.5 | L* | M10 | 6,5 | 12,58 | 145 | 64 | 63 | 11 | 8.4 |
| 1207900610 | 6 | 3.5 | R* | M10 | 6,5 | 12,58 | 145 | 64 | 63 | 11 | 8.4 |
| 1207910610 | 6 | 3.5 | L* | M10 | 6,5 | 12,58 | 145 | 64 | 63 | 11 | 8.4 |
| 1207900612N | 6 | 5.1 | R* | M12 | 6,5 | 12,58 | 162 | 64 | 80 | 11 | 11 |
| 1207910612N | 6 | 5.1 | L* | M12 | 6,5 | 12,58 | 162 | 64 | 80 | 11 | 11 |
| 1207900612 | 6 | 5.1 | R* | M12 | 6,5 | 12,58 | 162 | 64 | 80 | 11 | 11 |
| 1207910612 | 6 | 5.1 | L* | M12 | 6,5 | 12,58 | 162 | 64 | 80 | 11 | 11 |
| 1207900712N | 7 | 5.1 | R* | M12 | 7,5 | 14,20 | 170 | 70 | 80 | 12 | 13.3 |
| 1207910712N | 7 | 5.1 | L* | M12 | 7,5 | 14,20 | 170 | 70 | 80 | 12 | 13.3 |
| 1207900712 | 7 | 5.1 | R* | M12 | 7,5 | 14,20 | 170 | 70 | 80 | 12 | 13.3 |
| 1207910712 | 7 | 5.1 | L* | M12 | 7,5 | 14,20 | 170 | 70 | 80 | 12 | 13.3 |
| 1207900714N | 7 | 6.8 | R* | M14 | 7,5 | 14,20 | 180 | 70 | 89 | 12 | 16 |
| 1207910714N | 7 | 6.8 | L* | M14 | 7,5 | 14,20 | 180 | 70 | 89 | 12 | 16 |
| 1207900714 | 7 | 6.8 | R* | M14 | 7,5 | 14,20 | 180 | 70 | 89 | 12 | 16 |
| 1207910714 | 7 | 6.8 | L* | M14 | 7,5 | 14,20 | 180 | 70 | 89 | 12 | 16 |
| 1207900812N | 8 | 5.1 | R* | M12 | 8,4 | 16,00 | 185 | 83 | 80 | 14 | 19.2 |
| 1207910812N | 8 | 5.1 | L* | M12 | 8,4 | 16,00 | 185 | 83 | 80 | 14 | 19.2 |
| 1207900812 | 8 | 5.1 | R* | M12 | 8,4 | 16,00 | 185 | 83 | 80 | 14 | 19.2 |
| 1207910812 | 8 | 5.1 | L* | M12 | 8,4 | 16,00 | 185 | 83 | 80 | 14 | 19.2 |
| 1207900814N | 8 | 6.9 | R* | M14 | 8,4 | 16,00 | 194 | 83 | 89 | 14 | 20 |
| 1207910814N | 8 | 6.9 | L* | M14 | 8,4 | 16,00 | 194 | 83 | 89 | 14 | 20 |
| 1207900814 | 8 | 6.9 | R* | M14 | 8,4 | 16,00 | 194 | 83 | 89 | 14 | 20 |
| 1207910814 | 8 | 6.9 | L* | M14 | 8,4 | 16,00 | 194 | 83 | 89 | 14 | 20 |
| 1207900816N | 8 | 8.7 | R* | M16 | 8,4 | 16,00 | 203 | 83 | 100 | 14 | 23 |

Thread Terminals Metric - TTM

Technical data

| Part code | Rope Ø range mm | MBL ton | Thread | G thread mm | D1mm mm | D2mm mm | L1mm mm | L2mm mm | L3 mm mm | KWmm mm | Weight kg/100pc |
|--------------|-----------------|---------|--------|-------------|---------|---------|---------|---------|----------|---------|-----------------|
| 1207910816N | 8 | 8.7 | L* | M16 | 8,4 | 16,00 | 203 | 83 | 100 | 14 | 23 |
| 1207900816 | 8 | 8.7 | R* | M16 | 8,4 | 16,00 | 203 | 83 | 100 | 14 | 23 |
| 1207910816 | 8 | 8.7 | L* | M16 | 8,4 | 16,00 | 203 | 83 | 100 | 14 | 23 |
| 1207901016N | 10 | 9.4 | R* | M16 | 10,5 | 17,80 | 210 | 89 | 100 | 15 | 35 |
| 1207911016N | 10 | 9.4 | L* | M16 | 10,5 | 17,80 | 210 | 89 | 100 | 15 | 35 |
| 1207901016 | 10 | 9.4 | R* | M16 | 10,5 | 17,80 | 210 | 89 | 100 | 15 | 35 |
| 1207911016 | 10 | 9.4 | L* | M16 | 10,5 | 17,80 | 210 | 89 | 100 | 15 | 35 |
| 1207901020N | 10 | 9.7 | R* | M20 | 10,5 | 17,80 | 230 | 89 | 120 | 15 | 35 |
| 1207911020N | 10 | 9.7 | L* | M20 | 10,5 | 17,80 | 230 | 89 | 120 | 15 | 35 |
| 1207901020 | 10 | 9.7 | R* | M20 | 10,5 | 17,80 | 230 | 89 | 120 | 15 | 35 |
| 1207911020 | 10 | 9.7 | L* | M20 | 10,5 | 17,80 | 230 | 89 | 120 | 15 | 35 |
| 1207901220N | 12 | 11.4 | R* | M20 | 12,5 | 20,00 | 249 | 105 | 120 | 17 | 45 |
| 1207911220N | 12 | 11.4 | L* | M20 | 12,5 | 20,00 | 249 | 105 | 120 | 17 | 45 |
| 1207901220 | 12 | 11.4 | R* | M20 | 12,5 | 20,00 | 249 | 105 | 120 | 17 | 45 |
| 1207911220 | 12 | 11.4 | L* | M20 | 12,5 | 20,00 | 249 | 105 | 120 | 17 | 45 |
| 1207901220XN | 12 | 14.2 | R* | M20 | 12,5 | 21,40 | 265 | 120 | 120 | 19 | 50 |
| 1207911220XN | 12 | 14.2 | L* | M20 | 12,5 | 21,40 | 265 | 120 | 120 | 19 | 50 |
| 1207901220X | 12 | 14.2 | R* | M20 | 12,5 | 21,40 | 265 | 120 | 120 | 19 | 50 |
| 1207911220X | 12 | 14.2 | L* | M20 | 12,5 | 21,40 | 265 | 120 | 120 | 19 | 50 |
| 1207901422N | 14 | 15.9 | R* | M22 | 14,8 | 25,00 | 308 | 140 | 140 | 22 | 76.8 |
| 1207911422N | 14 | 15.9 | L* | M22 | 14,8 | 25,00 | 308 | 140 | 140 | 22 | 76.8 |
| 1207901422 | 14 | 15.9 | R* | M22 | 14,8 | 25,00 | 308 | 140 | 140 | 22 | 76.8 |
| 1207911422 | 14 | 15.9 | L* | M22 | 14,8 | 25,00 | 308 | 140 | 140 | 22 | 76.8 |
| 1207901622N | 16 | 18.2 | R* | M22 | 17,0 | 28,00 | 333 | 160 | 140 | 25 | 97.8 |
| 1207911622N | 16 | 18.2 | L* | M22 | 17,0 | 28,00 | 333 | 160 | 140 | 25 | 97.8 |
| 1207901622 | 16 | 18.2 | R* | M22 | 17,0 | 28,00 | 333 | 160 | 140 | 25 | 97.8 |
| 1207911622 | 16 | 18.2 | L* | M22 | 17,0 | 28,00 | 333 | 160 | 140 | 25 | 97.8 |
| 1207901624N | 16 | 19.4 | R* | M24 | 17,0 | 28,00 | 363 | 160 | 170 | 25 | 111 |
| 1207911624N | 16 | 19.4 | L* | M24 | 17,0 | 28,00 | 363 | 160 | 170 | 25 | 111 |
| 1207901624 | 16 | 19.4 | R* | M24 | 17,0 | 28,00 | 363 | 160 | 170 | 25 | 111 |
| 1207911624 | 16 | 19.4 | L* | M24 | 17,0 | 28,00 | 363 | 160 | 170 | 25 | 111 |

Thread Terminals Metric - TTM

Technical data

| Part code | Rope Ø range mm | MBL ton | Thread | G thread mm | D1mm mm | D2mm mm | L1mm mm | L2mm mm | L3 mm mm | KWmm mm | Weight kg/100pc |
|-------------|-----------------|---------|--------|-------------|---------|---------|---------|---------|----------|---------|-----------------|
| 1207901927N | 19 | 23 | R* | M27 | 20,0 | 34,50 | 425 | 200 | 180 | 30 | 209 |
| 1207911927N | 19 | 23 | L* | M27 | 20,0 | 34,50 | 425 | 200 | 180 | 30 | 209 |
| 1207901927 | 19 | 23 | R* | M27 | 20,0 | 34,50 | 425 | 200 | 180 | 30 | 209 |
| 1207911927 | 19 | 23 | L* | M27 | 20,0 | 34,50 | 425 | 200 | 180 | 30 | 209 |
| 1207902230N | 22 | 28 | R* | M30 | 23,5 | 40,50 | 480 | 230 | 200 | 36 | 314 |
| 1207912230N | 22 | 28 | L* | M30 | 23,5 | 40,50 | 480 | 230 | 200 | 36 | 314 |
| 1207902230 | 22 | 28 | R* | M30 | 23,5 | 40,50 | 480 | 230 | 200 | 36 | 314 |
| 1207912230 | 22 | 28 | L* | M30 | 23,5 | 40,50 | 480 | 230 | 200 | 36 | 314 |
| 1207902636N | 26 | 41 | R* | M36 | 27,5 | 46,00 | 550 | 280 | 220 | 41 | 470 |
| 1207912636N | 26 | 41 | L* | M36 | 27,5 | 46,00 | 550 | 280 | 220 | 41 | 470 |
| 1207902636 | 26 | 41 | R* | M36 | 27,5 | 46,00 | 550 | 280 | 220 | 41 | 470 |
| 1207912636 | 26 | 41 | L* | M36 | 27,5 | 46,00 | 550 | 280 | 220 | 41 | 470 |