

Eye Grab Hook X-079

Product information



- At least 25% greater WLL than traditional Grade 8 products.
- Proof Load tested at 2.5 times the WLL with certification for each batch manufactured.
- Fatigue rated to 20,000 cycles at 1.5 times the WLL.
- Magnaflux crack detection is performed 100% on each batch.
- No reduction in WLL when shortening chain.

... [Read more](#)

Material: Quenched and Tempered Alloy Steel

Marking: According to standard, CE-marked

Temperature range: -40°C up to +200°C (without reduction in WLL).

Finish: Blue painted.

Standard: EN 1677-1

Safety factor: 4:1

Grade: 10

Eye Grab Hook X-079

Blueprint

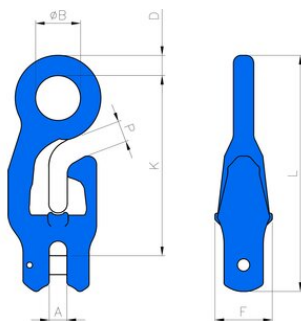

Technical data

Part code	Chain diameter mm	WLL ton	A mm	B mm	D mm	F mm	K mm	L mm	P mm	Weight kg
402300140760	5-6	1.4	8	18	9	24	76	99	12	0.24
402300250760	7-8	2.5	10	24	13	32	102	134	12	0.54
402300400760	10	4	12	31	14	40	125	163	15	1.03
402300670760	13	6.7	16	37	18	51	158	208	20	2.18
402301000760	16	10	19	48	24	64	202	264	21	4.39